



## 75DP30FE

### 75" 4K UHD DIGITAL SIGNAGE DISPLAY

The Hisense DP30FE is a high-performance 4K digital signage solution built for 16/7 operation, offering outstanding reliability and value across diverse commercial settings—including museums, stadiums, retail stores, and corporate offices. Combining powerful content management with remote device control, it enables real-time updates, data-driven insights, and engaging visual experiences that captivate audiences. The DP30FE's intuitive home screen interface ensures effortless usability, while remote access makes device control simple and efficient from anywhere. Designed to deliver professional-grade performance at a competitive price, the DP30FE offers exceptional value for businesses looking to elevate their communications.

#### Highlights



##### Captivating 4K Visuals

With 85% NTSC color coverage and 4K Ultra HD resolution, every detail is rendered in studio-grade precision. Featuring 1.07 billion colors and professional-grade color accuracy, this display delivers unparalleled clarity and vibrancy for professional-grade photo and video viewing.



##### 178° Wide Viewing Angle

178° Ultra-Wide Viewing Angle ensures vibrant visuals from any direction — perfect for high-traffic retail stores, museums, and stadiums. Engage passersby with crisp content that stays vivid, even at extreme angles.



##### Landscape and Portrait

The display seamlessly adapts to both portrait and landscape modes, enabling flexible installations in retail spaces, museums, stadiums, and corporate environments while maintaining 4K visual consistency across orientations.



##### Anti-glare with 25% haze

The 25% haze panels effectively minimize reflections while maintaining optimal image quality, make sure the critical information are always visible. Additionally, the anti-glare coatings enhance the perceived contrast ratio, delivering a sharper and more vibrant visual experience.



##### Smart Ambient Light Sensor

The display's built-in ambient light sensor automatically adjusts brightness to ambient conditions, ensuring optimal viewing comfort. Certified with Energy Star certification, it reduces energy consumption while delivering eco-conscious performance without compromising visual quality.



##### Built-in VisionInfo

VisionInfo is a cloud-based platform providing end-to-end content management, scheduling, remote updates, and centralized device control. This powerful yet user-friendly platform enables seamless device management and real-time monitoring from any location.



## Specifications

### Digital Display Panel

Backlight Type	DLED
Type	ADS
Size	75"
Resolution	3840 x 2160
Refresh rate	60Hz
Color Depth	1.07G (8 Bits+FRC)
Brightness(Typ.)	350 nits
Contrast Ratio(Typ.)	1200:1
Response Time(Typ.)	8ms
Viewing Angle(Min.)	178°/178°
Color Gamut(Typ.)	85% NTSC
Haze	25%
Orientation	Landscape & Portrait
Lifetime	up to 30,000 hrs
Operation Hours	7Day x 16Hour

### System

Operating System	Android 9
Memory	2G DDR4
Storage	16G EMMC
Language	Simplified Chinese, English, French, German, Polish, Spanish, Russian, Italian, Finnish, Norwegian, Swedish, Hebrew, Arabic, Thai, Malay, Indonesian, Catalan, Japanese

### Connectivity

Input	HDMI(2.0) x 3 USB2.0(A) x 2 RS232(RJ45) x 1 LAN(RJ45) x 1
Output	Audio(3.5mm) x 1

### Environment

Operating Temperature	0°~40℃
Operating Humidity	10%~80% Non-Condensing

### Power

Power Supply	AC 100~240V (50/60Hz)
Power Consumption (Typ.)	155W
Power Consumption (Max.)	230W
Standby Consumption	<0.5W (Standby Mode)

### Speaker

Built-in Speaker	10W x2
------------------	--------

### Physical

Bezel Color	Black
Set Dimension(W×H×D )	1668.4 x 962.3 x 76.1mm
Bezel width(T/L/R/B)	T: 9mm, L/R: 3.1mm, D: 16mm
Net Weight	25.6kg
Packing Dimension (W×H×D)	1865 x 1146 x 188mm
Gross Weight	36.3kg
VESA Mount	600mm x 400mm

### Certification

Standard Certification	CB/CE/ERP/SouthAfrica Energy Efficiency/CTUVus/CEC/FCC
EMC	Class B
Enviroment	Energy Star 8.0
IP Rating	IP5X



### Dimensions

**75"** 1668.4 x 962.3 x 76.1mm  
25.6kg

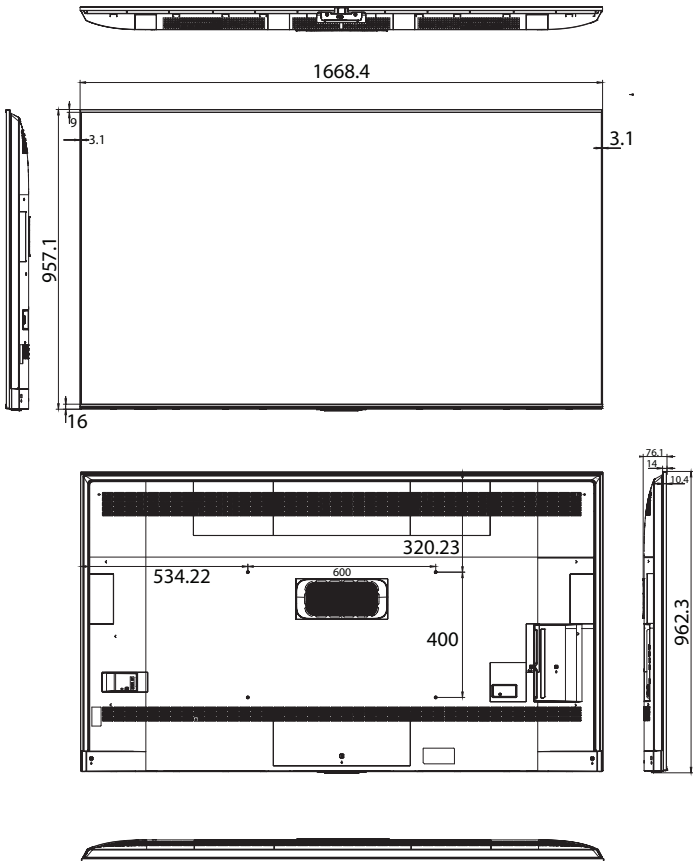

Product specifications may vary per region, and specifications are subject to change. This material may include corporate names and trademarks of third parties which are the properties of the third parties respectively.

Learn More: [www.hisense-b2b.com](http://www.hisense-b2b.com) | Contact Us: [sales@hisense-b2b.com](mailto:sales@hisense-b2b.com)

LinkedIn: @Hisense Commercial Display | @Hisense B2B Europe | @Hisense B2B USA | @Hisense B2B Australia